



USER MANUAL

ORACLE SERIES

**OZ-FDL-11-LIFE | OZ-FDL-11-R-LIFE
OZ-FDL-11-P-LIFE**



Fingerprint



Password



Mobile App



RFID Card



Emergency Key

WORKS WITH:



DOWNLOAD NOW



OzoLife iOS



OzoLife Android



OzoLife

WWW.OZONESECUTECH.COM

EMAIL ID: INFO@OZONESECUTECH.COM | CUSTOMER CARE: +91-9310012300

INDEX



Product Introduction	2-3
Functions	4
Installation	5-6
Operation	7
Add Lock	8
Factory Reset & Dynamic Passcode	9
Add Unlock Modes	10
Add User	11
Features	12-13
Add Gateway	14-15
Passage Mode	16
Secure Lock Mode	17
Initialization and Delete Lock	18-19
FAQs	20
Warranty Card	21-22

PRODUCT INTRODUCTION

This smart lock is a new type of intelligent door lock. Advanced electronic and biometric technology enables the smart lock to have intelligent recognition capabilities, making work and life easier and more convenient for the users.

This smart lock can be used for homes, commercial spaces, offices, residential buildings and more.

Please read this manual carefully before using the product.



PRODUCT INTRODUCTION

UNLOCK MODES

FINGERPRINT
PASSCODE
RFID CARD

UPTO 100 USERS

MECHANICAL KEYS

OZOLIFE APP

POWER SUPPLY

4 AA BATTERIES

SCRAMBLE CODE

15 DIGITS TOTAL

WORK TEMPERATURE

-25~700 C

FINGERPRINT TYPE

SEMICONDUCTOR EMBEDDED FINGERPRINT

DOOR THICKNESS

35MM - 65MM

COLORS AVAILABLE

OZ-FDL-11 LIFE

● BLACK ● BRONZE

OZ-FDL-11-R LIFE

● GOLD

OZ-FDL-11-P LIFE

● ANTIQUE BRONZE

SAFETY ASSISTANT FUNCTION

PASSAGE MODE

When you need to open/close the doors frequently.

LOW BATTERY ALARM

When the voltage is lower than 4.8V, the alarm is activated each time the lock is unlocked. The lock could be unlocked 200 times, after the first alarm.

SCRAMBLE CODE FUNCTION

It supports front and back dummy passcodes to prevent from peaking.

SECURE LOCK MODE

Except for the administrator, any other user cannot unlock the door.

ACCESS RECORDS QUERY

You can check access records anytime.

USB EMERGENCY INTERFACE

You can charge the lock to unlock the door, when the battery runs out.

INSTALLATION

PARTS INCLUDED

Front Handle



Rear Handle



Connecting Screws



Lock Body



Connecting Rod



Square Bar



Double-headed Screws



STEPS TO INSTALL

01

Accessories selection table

Door Thickness	Square Bar	Connecting Rod
35mm-50mm	73mm	30mm
50mm-65mm	88mm	40mm

Step1: Install lock body and select right connecting rod & square bar according to the door thickness



03

Step 3: Turn square bar and adjust the direction of locating hole according to door opening direction.

- 1.If lock is on the left side of the door from outside the home, turn the direction of locating hole to "R".
- 2.If lock is on the right side of the door from outside the home, turn the direction of locating hole to "L".

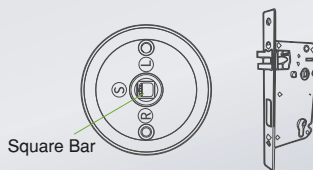

02

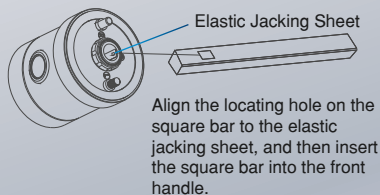
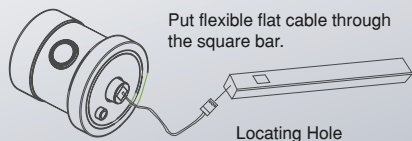

04

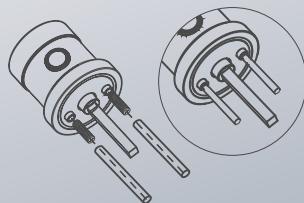

1. Fix the black double-headed screws into the front handle tightly.
2. Fix the connecting rod onto the black double-headed screws.

Insert front handle into the latch.

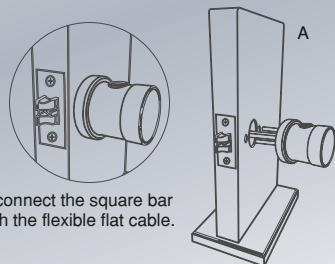

Note: Make sure to connect the square bar with the latch through the flexible flat cable.

05



Before



After

Organize flexible flat cable and put it into the square hole of part A to avoid the cable being crushed.

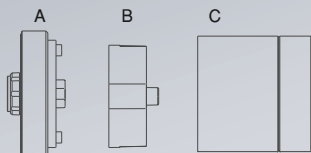

Disassemble the rear handle into 3 parts, as shown in Figure A, Figure B and Figure C.

Note: Please don't lose the screws.

08

Insert 4 AA batteries as per the positive and negative poles. Install Part C and fix the screw tightly.

Note: Make sure to secure the lock button upwards as shown in the figure.

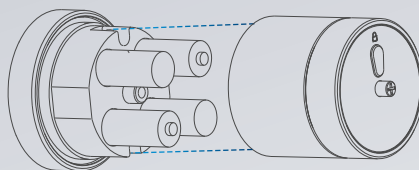

C

06

Install Part B as shown in the picture.

Note: Make sure the button hole of Part B is aligned to the Button of Part A, as shown in the figure.

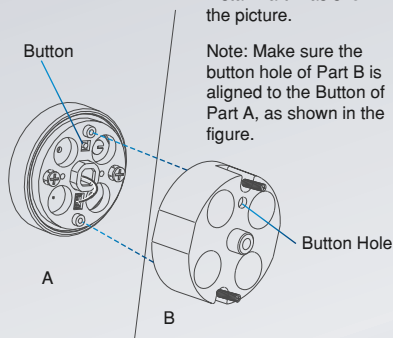

07

1. Install Part A by aligning it to the square bar as shown in the figure (button upwards, socket downwards), and then fix the connecting screws tightly.

2. Insert the plug of the flexible flat cable into the socket.

Note: Turn the centre screw to adjust the connecting screws to avoid that the screw on one side is not too tight and the screw on the other side is not too loose.

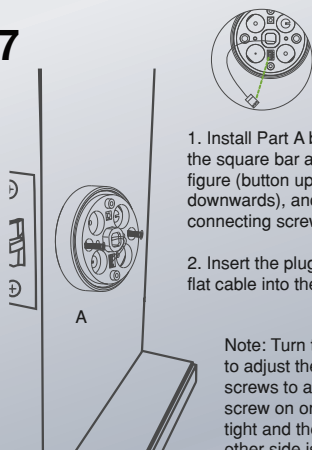

09

Step 12: Install lock cylinder (the keyhole faces outside)

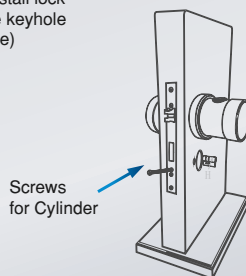

Screws for Cylinder

10

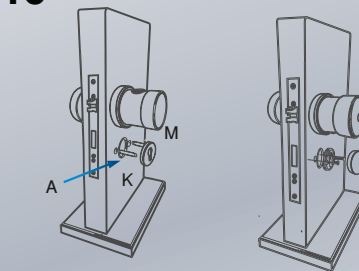

- 1) Install the inner escutcheon part and fastening the screws in the front and back side.
- 2) Screw the escutcheon cover on the inner escutcheon.

OPERATION

REGISTER

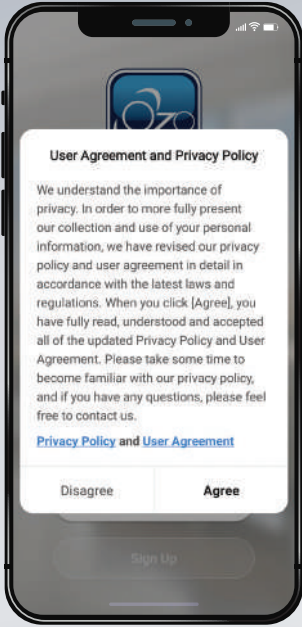

1 Click on “Sign Up” and read the Privacy Policy after it pops up. Click on “Agree” to enter the registration page.

2 You can use email or mobile number for account registration. The country/region of the app will be the same as the country/region of your phone. You can also change it while registering. Note: You cannot change the country/region after the registration).

3 Enter mobile number/email and click on “Get Verification Code” to get the same.

4 Enter the verification code to proceed to the password setting page. Set your password as required and click on “Done”.



LOG IN

If you already have an account, choose “Log in”, and enter your login details.

1 The system will automatically locate the current country/region you are in. You can also choose the country/region manually.

2 Enter mobile number/email and password.

3 Third-party Social Account Log in - You can also log in using your Facebook/Google account after authorizing it. If you are using iPhone, you can also log in with your Apple ID.

ADD LOCK

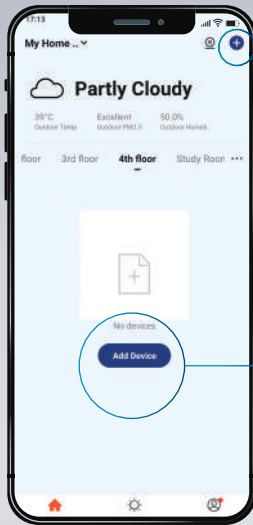

1 Tap on Add Device on the home page or “+” on the top right corner of the page to go to the Add Device page. Then, you can manually add devices or search for devices to add to the app.



2 Click on the “Digital Locks” category on the left. Find the door lock (bluetooth).



3 Touch the keypad wakes the device up. The lock will enter bluetooth search mode.



4 After searching for the door lock, click on “+” to add.

FACTORY RESET

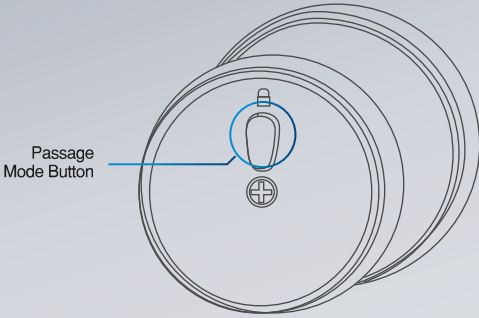

Turn Rear Handle left or right, and then press secure lock button, and hold for 10 seconds, accompanied by a continuous beep. After the lock is initialized, all fingerprints, passcodes, IC cards are deleted from lock.

DYNAMIC PASSCODE

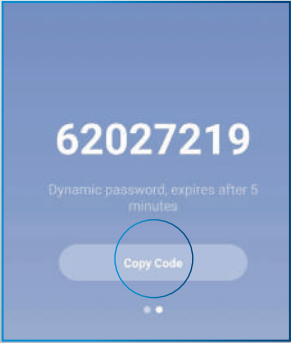
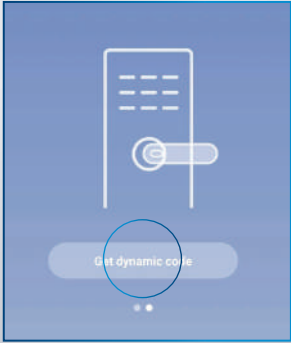

Slide your finger on the phone screen on the main interface, as shown in Figure A, and click "Get dynamic code". You can copy the passcode, which expires in 5 minutes.

ADD UNLOCK MODES



In main interface, select “Member Management”, select “User”, and then select to add door card, fingerprint, or passcode.

For example, to add fingerprint: Select “finger” function, then click “+”, and then click “start collecting” to start inputting fingerprint. After capturing fingerprint for 4 times, fingerprint is added successfully .

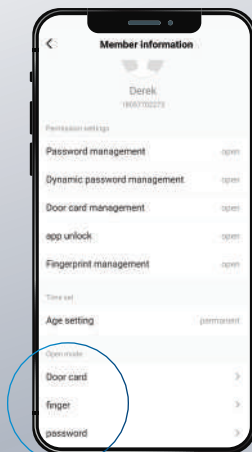
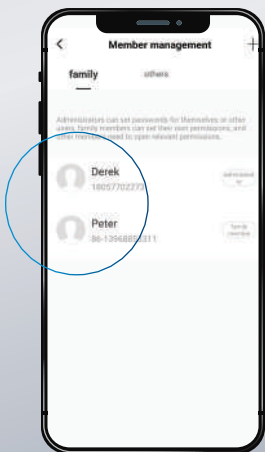

ADD USER

MEMBERS AND MANAGEMENT

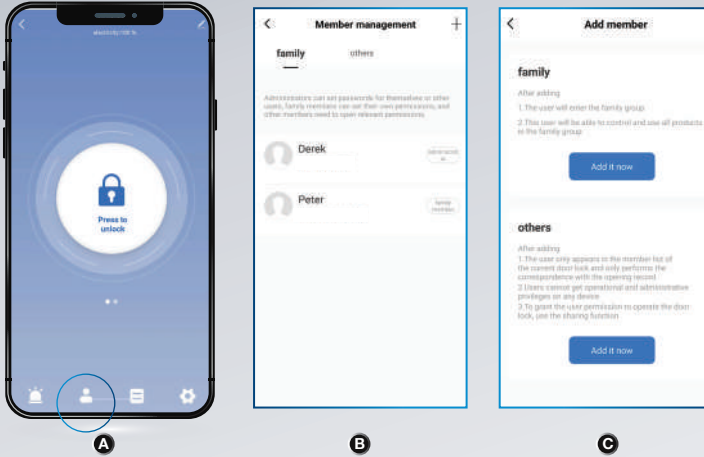

Family: The user will enter the family group. And this user will be able to control and use all the products in the family group.

Others: The user appears only in the member list of the current door lock and can only perform open lock functions.

By selecting “Others”, the permission and the validity period of the users can be set. To grant the user permission to operate the door lock, use the sharing function.

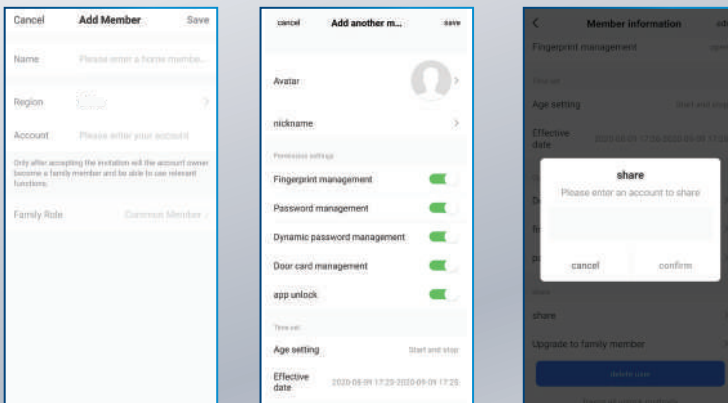

FEATURES

OPENING RECORD

You can check the door logins in the door opening log. The records are arranged in reverse order. The unlock ID that has been associated with a username, will display the corresponding username; while the unlock ID that has not been associated with any username, will display the specific unlock ID.

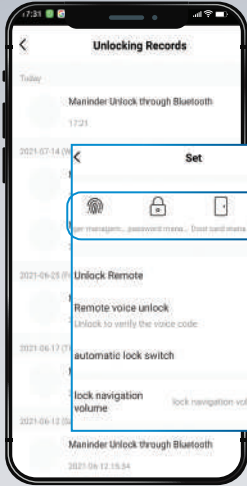

About the Opening Log display:

When the door lock is connected to the mobile phone bluetooth, the door opening record will be displayed in the app in real time, apart from being cached locally in the door lock, waiting for the next time the door lock is connected with the mobile phone bluetooth and the door is opened for supplementary transmission.



A Homepage setting entrance-you can set fingerprint, password, card, temporary password, automatic lock and volume setting.



B If you turn on the automatic lock setting, it will be automatically lock five seconds after unlocking. If you turn off this setting, the lock is in normal open mode, if left open.

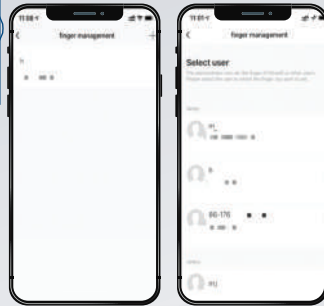

By connecting the door lock via bluetooth app, the administrator can enroll fingerprints for himself or other family members; before enrolling, select the user corresponding to the fingerprint. Click "Start Enrolling" to enter the fingerprint enroll interface. Each collection needs the fingerprint to be entered five times.

PASSWORD MANAGEMENT

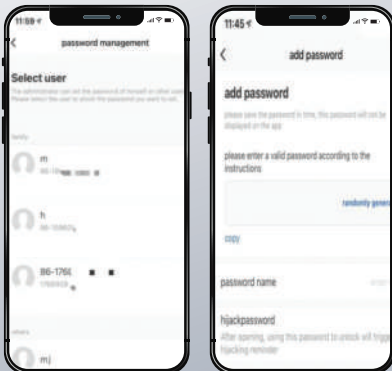

Connect the door lock with App through Bluetooth, the administrator can enter the password for themselves or other family members; before adding the password, select the user corresponding to the added password

Click on "Add Password" to enter the password entry interface, which supports random generation and custom passwords. Remarks: The hijacking password refers to opening the account. Using this password to open the door will trigger an app hijacking alarm (the same applies to fingerprints and door cards).

DOOR CARD MANAGEMENT

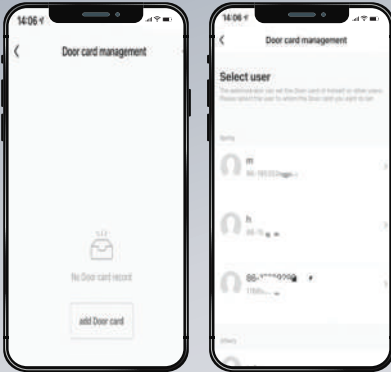

Connect the door lock with App through Bluetooth, the administrator can enter the door card for themselves or other family members; before adding the door card, select the user corresponding to the added door card and click on "Add door card" to enter the card entry interface, and place the card on the door lock which corresponds to the sensing area for swiping input.

TEMPORARY CODE MANAGEMENT

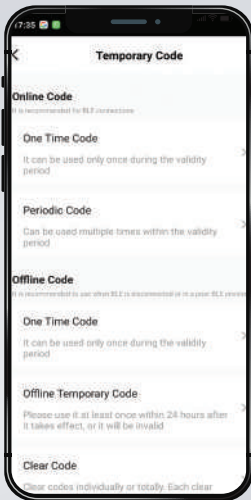

Online Code:

By connecting the door lock via bluetooth app, the administrator can enter a temporary password for himself or other family members, choose a one-time password or a periodic password as needed.

Offline Code:

When the bluetooth is not connected, you can still generate One-time Code, Offline Temporary Code and Clear Code. These passwords are randomly generated and do not need to be set.

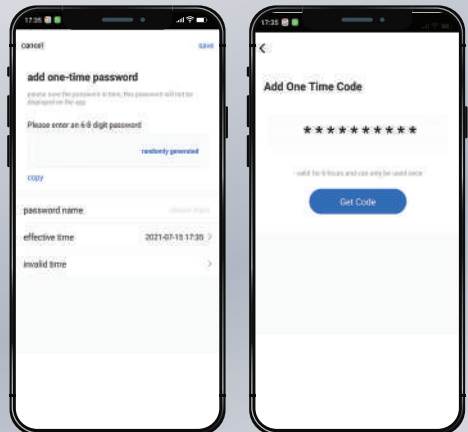

ADD GATEWAY (OPTIONAL)

ADD BLUETOOTH GATEWAY

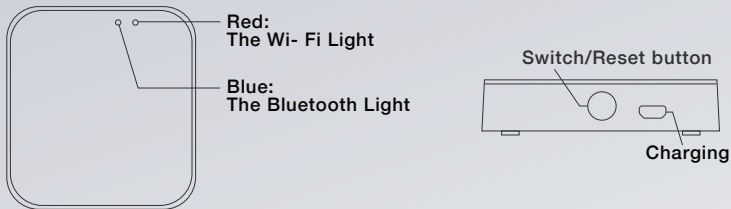
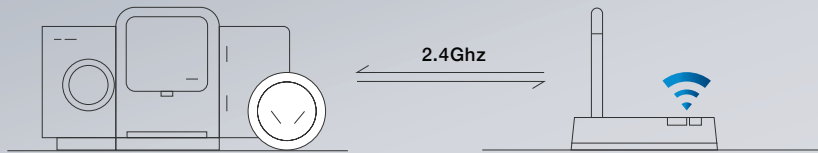

- 1** Power on the gateway. Turn on the phone bluetooth and connect to 2.4g Wi-Fi (note that if the router supports both 2.4g and 5G modes, the phone must be connected to a 2.4g network; 2.4g and 5G hybrid modes are not supported).
- 2** After the gateway is powered on and stable, confirm that the WiFi indicator light is glowing blue. If the indicator is in other state, long press the reset button near the power jack until the blue light starts glowing. The positions of the indicator and the button are as shown in the picture.
- 3** Click the "Add Device" button or the "+" in the upper right corner -- "Select Gateway control" -- "Wireless Gateway (bluetooth) ", as shown in picture 1.
- 4** As shown in picture 2, reset the device as prompted, confirm that the red indicator flashes, search for the devices and complete the addition.



ADD DOOR LOCK TO THE BLUETOOTH GATEWAY

THERE ARE TWO WAYS TO ADD BLUETOOTH DOOR LOCK DEVICE UNDER BLUETOOTH GATEWAY

Method 1:

Enter the bluetooth Gateway Device App panel (as shown in picture 1), select add in the list, and jump to the list of bluetooth door lock devices that have been added (as shown in picture 2).

Method 2:

Select the new device to search, select the "door lock" sub-device (as shown in picture 3), and start the bluetooth door lock distribution network process.

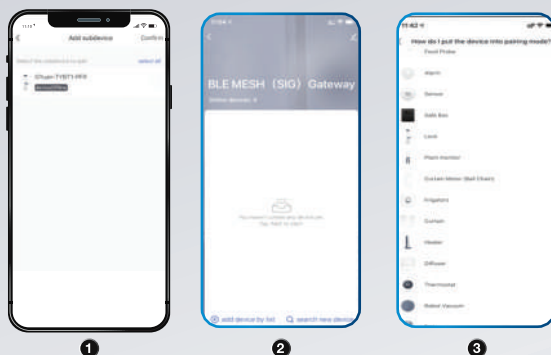

Note

- 1 You need to reset the time after replacing the battery, each time.
- 2 The lock can be opened using default code 123456 followed by # in trial mode.
- 3 When the voltage is lower than 4.6V, the lock will automatically raise an alarm every time. After the alarm, the lock can be unlocked for 200 times. After these number of times, the delay time of each lock opening session will be 2 seconds.
- 4 Passage Mode: When the touch screen is lit, a voice prompt "Please enter lock information" comes. At this point, enter valid lock information. Press "5" and then press "#", and the voice prompt "passage mode, please pay attention to lock" comes to open passage mode. Enter valid unlock information again. Passage mode closed.

PASSAGE MODE

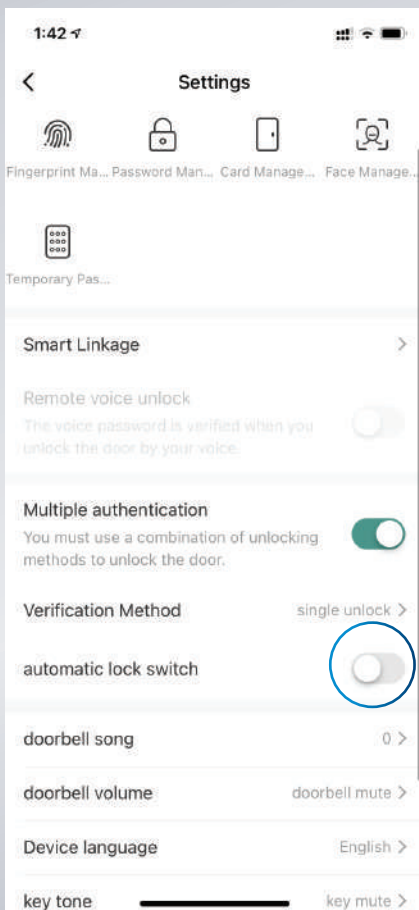

To set up Passage Mode ,enter a lock interface and enter the setting menu. Then click Automatic Lock Switch (open or close).

* When Automatic Lock Switch is grayed out ,passage mode is open.

SECURE LOCK MODE

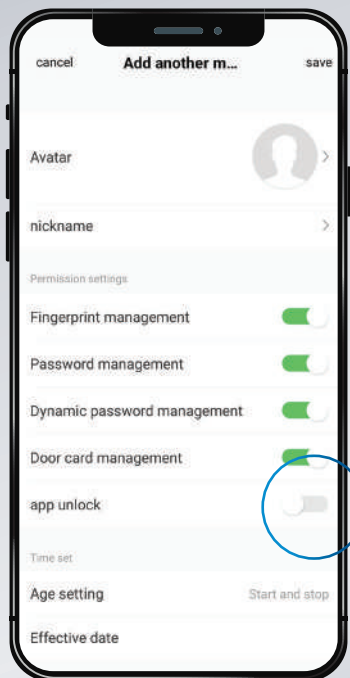

ACTIVATE SECURE LOCK MODE

Long press secure lock button for more than 3 seconds to activate secure lock mode.

- In this mode, the lock can be opened by the App.
- When you do authorization, App function could be banned. In this mode, the lock can only be opened by the App, and cannot be opened by any user's fingerprint, passcode and card.

DEACTIVATE SECURE LOCK MODE

Turn rear handle to deactivate secure lock mode.

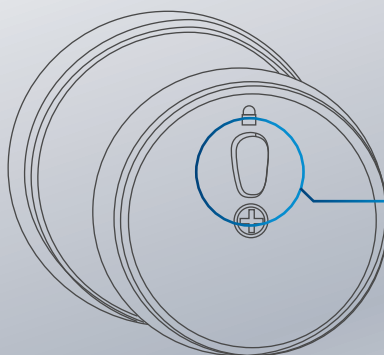

Secure
Lock Button

INITIALIZATION AND DELETE LOCK

Confirm that the lock to be deleted is online. Select the lock and hold for a while, then click on "Remove Device", and click "Confirm" to delete and initialize the lock.

(Note: If the lock is offline, you need to slide your finger on the phone screen on the main interface to get the lock online.)

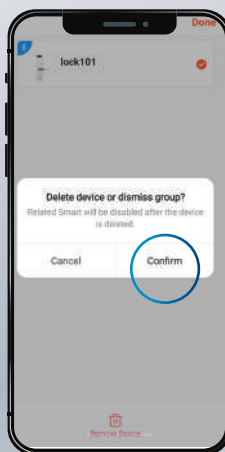
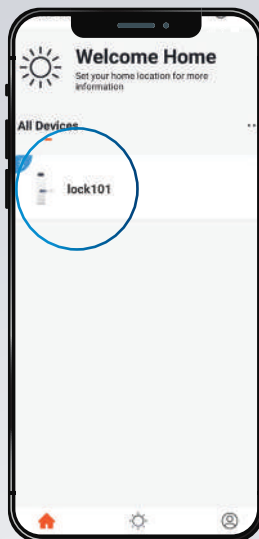

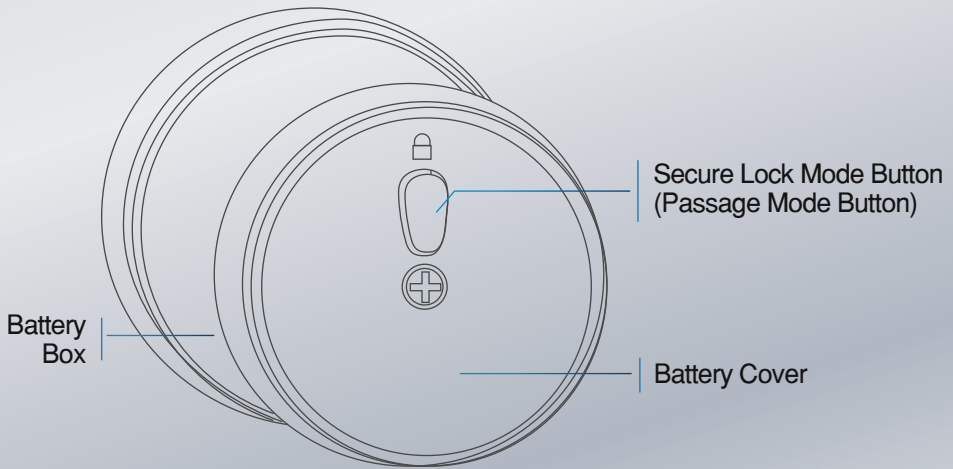
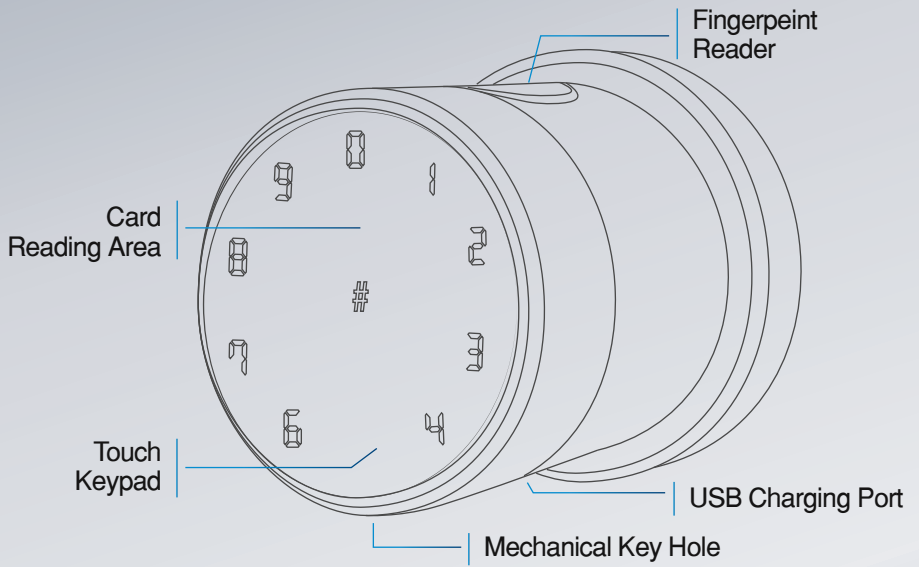

FAQS

1 How to read operation records?

Select "Opening record" option on lock main interface

2 Why can't I unlock it after opening the passage mode?

You need to perform an unlock verification in any method, only then the passage mode will take effect.

3 What is the purpose of Auto Lock option?

You can use it to set how long the lock stays open after unlocking.

4 After installation, touch sensing keyboard or screen not responding.

- First check that the positive and negative electrodes of the battery have been installed upside down.
 - Check whether the battery has enough power.
 - Remove the back panel body and see if it's connected with the front panel.
 - Remove the lock and check whether the connecting wires of lock body are not squeezed or twisted.
-

5 Unable to register fingerprint.

- Check the fingers for dirt or wear. Also check the fingerprint sensor on the lock for dirt and oil stains, etc.
 - Check if the fingerprint sensor is working properly (Press any fingerprint on sensor to see if there is any response).
-

6 Why is the smart lock consuming power faster than usual?

- Large standby power consumption.
 - Short circuit.
-

7 There is no response to pressing the handle on outside the door but the door is unlocked normally from inside, the user verification is successful and the motor function is normal.

Kindly check if the triangle direction on the clutch is properly aligned.

8 After how many incorrect password attempts will the lock go in auto secure mode? For how long it will be in auto secure mode?

Every time you enter a wrong password more than 5 times in a row, the keyboard is locked for 90 seconds.

WARRANTY CARD



CUSTOMER DETAIL			
Name		Address	
Mobile No.			
E-Mail ID			
City		Landmark	
State		Pin Code	

PRODUCT PURCHASE DETAIL			
Digital Door Lock		Dealer Name & Address	
Model No.			
Online / Offline		Installation Address	
Serial No.			
		Invoice No.	
		Total Quantity	

Serial No.	Floor No.	Flat No.	Warranty No.	Remarks

Customer Signature:

Technician Signature:

Date:

Special Instructions:

- Please replace the battery as soon as the low voltage alarm signals it.
- Read this manual carefully before installation and keep it safe, for future reference.



OzoLife

